

Noosa North Shore Eco-Tourism Portal

Queensland

Project Type

Resort redevelopment

Date

2003

ESD Role

Enquiry by Design leader

Project Size

70 hectares

Client

Petrac Development & Older's Investments

Implementation Status

First stage complete

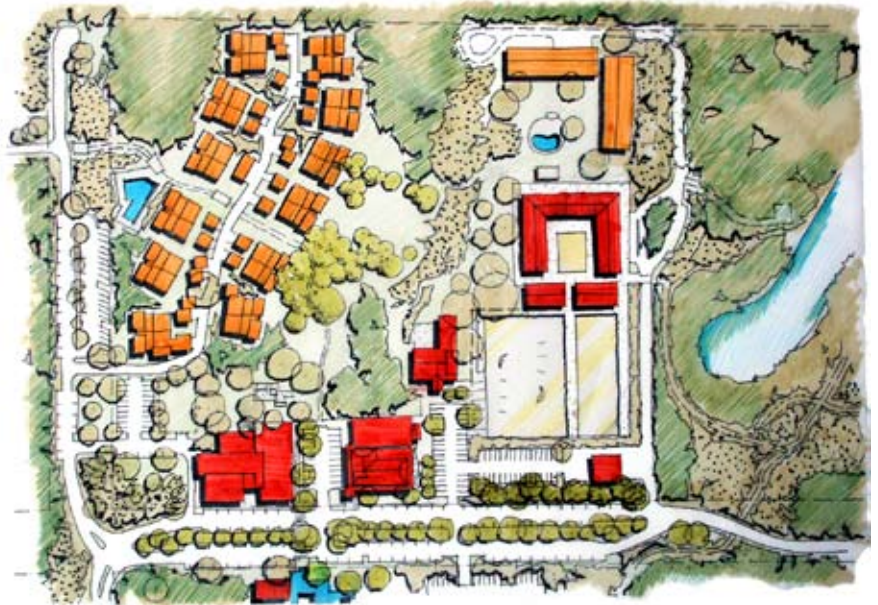

Petrac Development hired ESD in 2003 to lead an Enquiry by Design in vehemently anti-growth Noosa Shire, to consider how and whether to redevelop and expand a somewhat tired but brilliantly located existing 70ha resort in North Noosa. The site is surrounded by beautiful and ecologically sensitive parklands bounded by the Noosa River and the ocean, and functions as the gateway to the northern beaches and Fraser Island.

The five-day Enquiry by Design engaged extensively with local stakeholders, who decided to support the project. After less than two years, Noosa Shire unanimously approved the project in full, and now publicly positions this process as its preferred means of addressing complex urban projects.

Another in-house Enquiry by Design, led by ESD, catalysed the house designs and character of the project (see photos of houses).

The design revamps and expands the existing resort and includes about ninety 'eco-cabins', each nestled carefully into its own landscape. The first eco-cabin stage is selling at very high values and is partially complete, and the resort has been refurbished.

